



slidersuk

www.sliders-uk.com

The Ultimate Inline Sliding Patio Door

Part of the exclusive range available from Sliders UK



Reliability and performance by design



Trouble free installation and through life performance

Available in two, three and four pane options, the Ultimate Inline Sliding Door delivers exceptional performance, making it one of the most widely specified patio doors in the UK.

Offering enhanced security and PAS24/Part Q accredited options, plus installation efficiencies, the Ultimate Duraflex Inline Sliding Door by Sliders UK is defined by great performance and great sightlines.

This includes featured and bevelled options, plus a complete range of the latest solid colour and wood grain foils.

Trouble free installation and proven reliability mean that this continues to be a 'fit and forget', no-nonsense product, enjoying exceptional appeal in retail, social and new build sectors.

Wide ranging appeal



BS6375-1:2009 Weather Tested

Security



Heavy weight design

Fully reinforced and employing heavy duty steel rollers, the Ultimate Duraflex Inline Sliding Door by Sliders UK is available in two, three and four leaf configurations, accommodating maximum openings of up to 5950mm wide.

Combined with a choice of featured or bevelled designs and low threshold options, the Duraflex Inline Sliding Door delivers the core product performance and aesthetic flexibility, to take on a wide variety of projects.

Full integration with Duraflex's Diamond suite, plus an extensive choice of foiled and solid colours, means it offers an exceptional match to a wide range of PVC-U window systems.

Advanced performance

Featuring Duraflex's patented Q-Lon gasket system, which achieves 99% compression recovery, the Ultimate Duraflex Inline Sliding Door is fully tested to BS6375-1:2009.

This includes 600Pa air permeability; 200Pa water tightness; and 900Pa wind load.



The Ultimate Duraflex Inline Sliding Door from Sliders UK features a high performance eight-point locking system with dead-bolt and one-piece keep.

This is combined with a unique dual purpose anti-lift/sash stabilizing trim which increases security and assists in the smooth location of lock into the keep plate.

With a robust anti-pick, drill and tamper cylinder and handle, it's available in Part Q approved and PAS24 options, making it one of the UK's most secure inline sliding doors.



*Tests results two pane external slider
**Subject to specific site conditions and wind loads.

Project defining aesthetics



Finish options



Performance engineering

The Ultimate Duraflex Inline Sliding Patio Door is highly engineered making installation simple and guaranteeing trouble free through life performance. With a choice of different designs and finishes it also incorporates a high degree of flexibility, making it suitable for installation in a wide range of settings and applications.

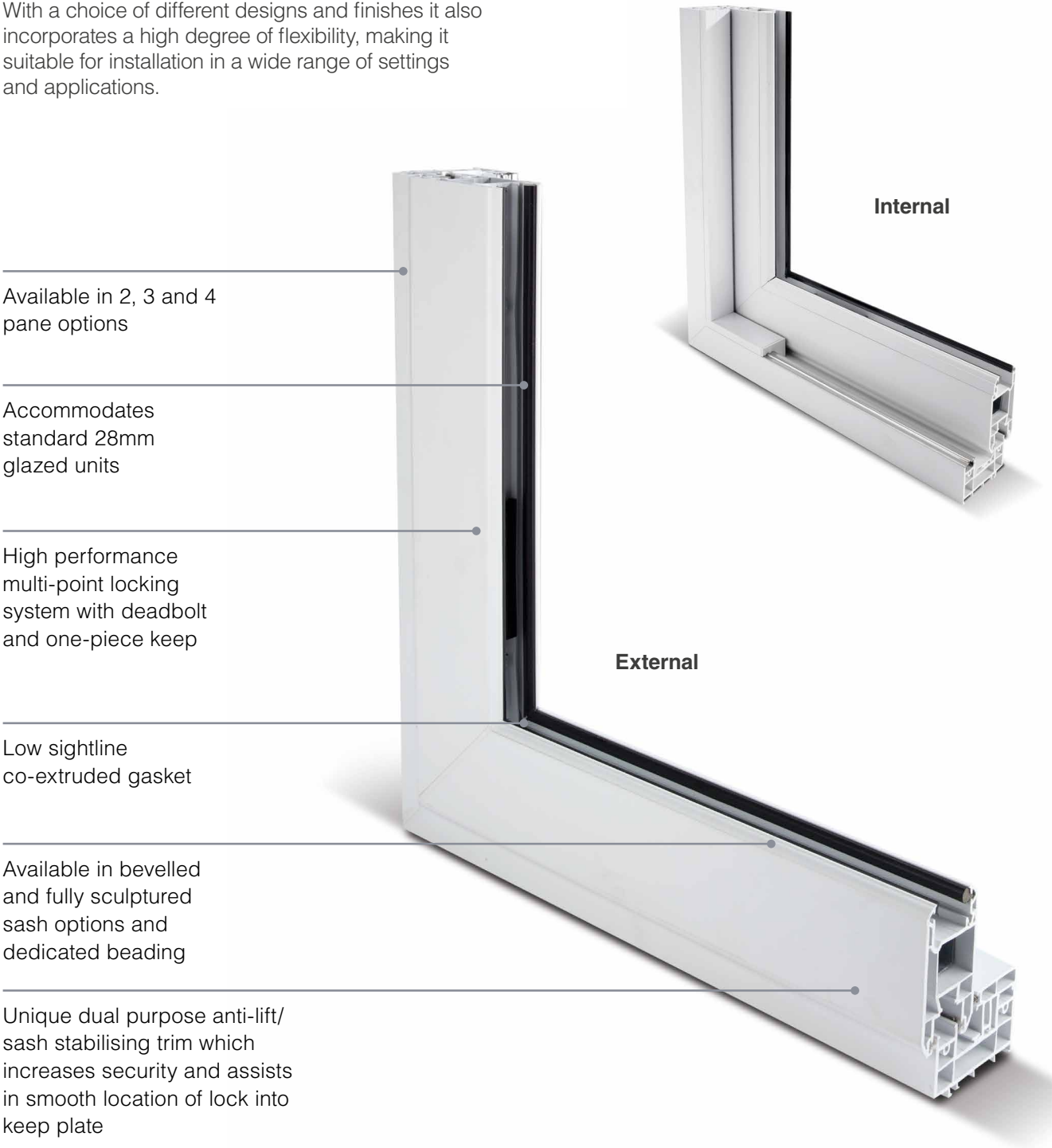

Profile colours

The Ultimate Duraflex Inline Sliding Patio Door is available in a complete range of solid and woodgrain foils.

	White 9010		Cream 9001		Golden Oak 8003		Mahogany 8017
	Light Grey 7001		Slate Grey 7015		Rosewood 8017		Irish Oak
	Dark Grey 7016		Black/Brown 8022		Chartwell Green		

Door handle options



Configurations



Suitable for openings ranging from a minimum 1400mm (two pane) to maximum 5950mm (four pane) The Ultimate Duraflex Inline Sliding Door by Sliders UK is flexible enough to accommodate almost any project.

Maximum sizes by combination:

2 pane Max width: 3040mm Max height: 2430mm

3 pane Max width: 4590mm Max height: 2430mm

4 pane Max width: 5950 Max height: 2430mm

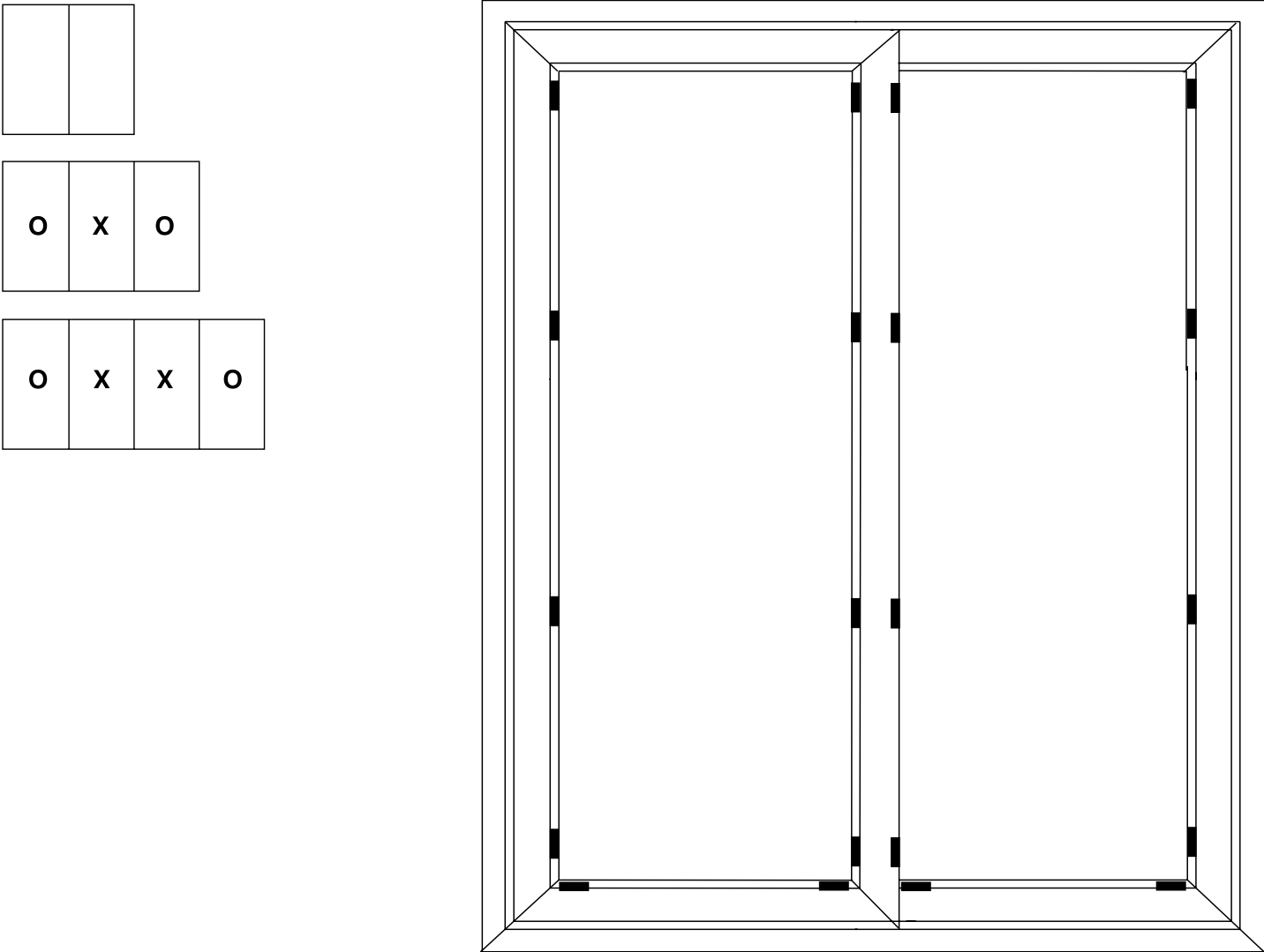

Technical information

Cross sections

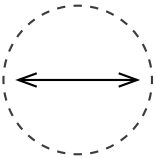

Outerframe

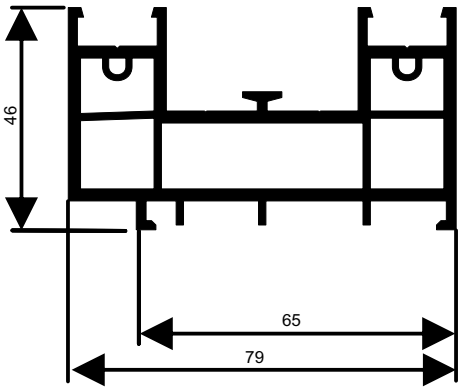

Outer Frame

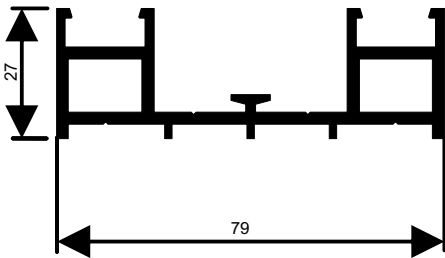

Low Threshold

Sashes

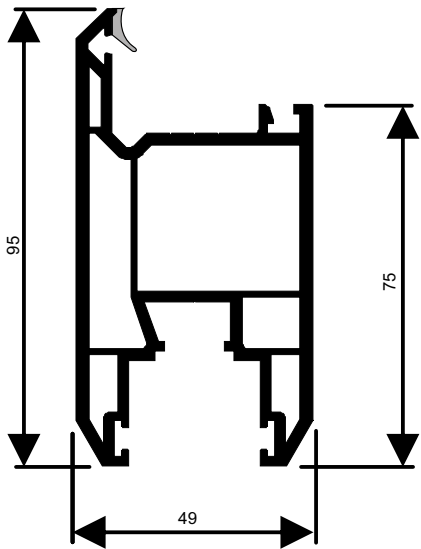

Bevelled Sash

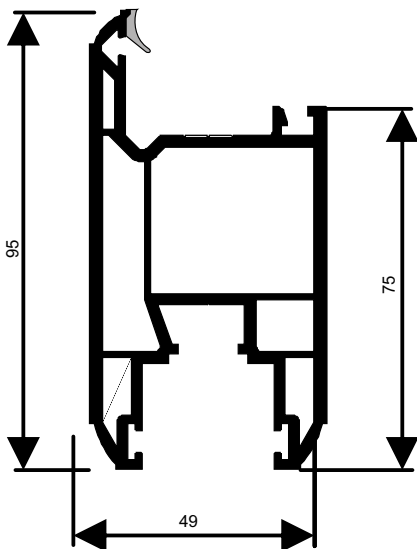

Feature Sash

Technical information

Threshold options

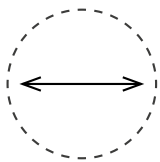

The Ultimate Inline

Sliding Door



Standard threshold

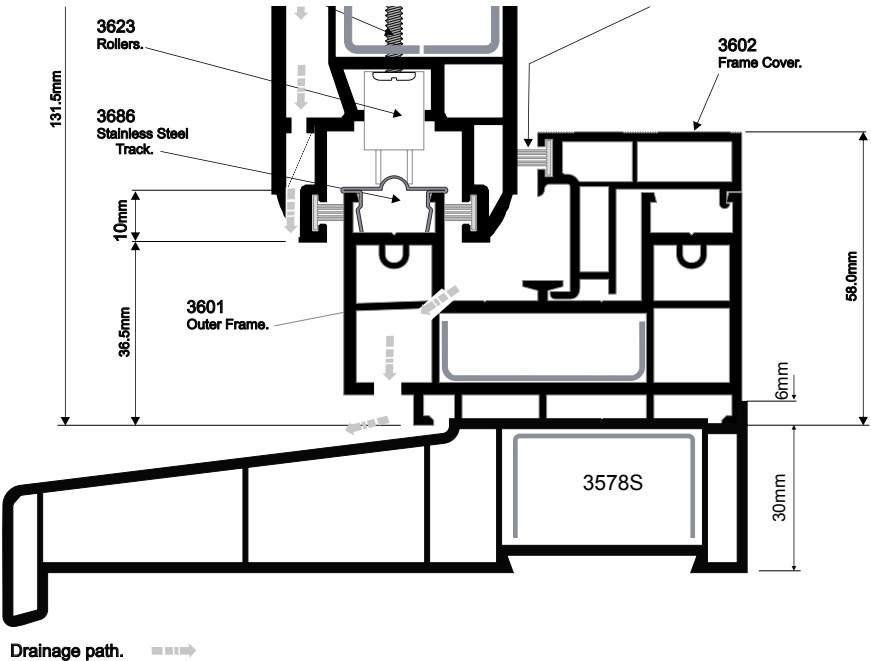

Low threshold

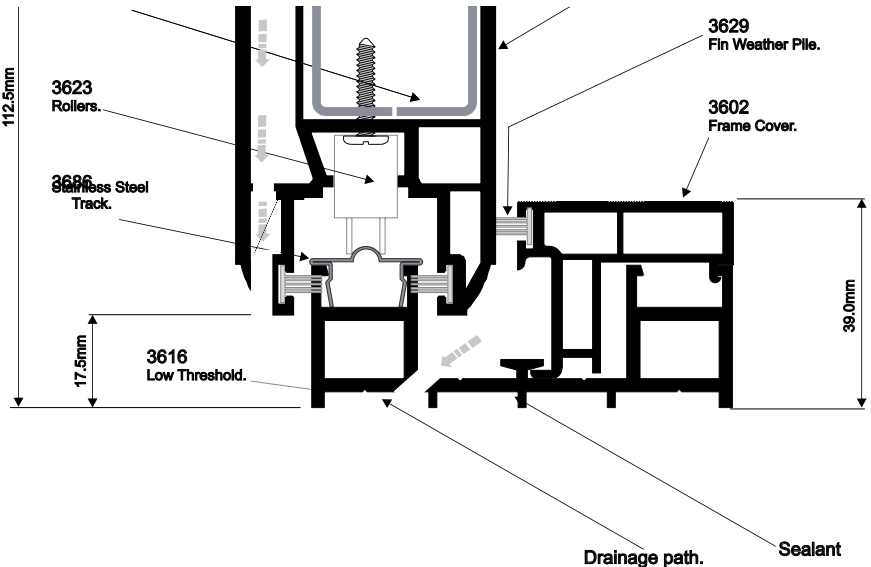

PAS24 and Part Q accredited

Available in 2, 3 and 4 pane options

High performance multi-point locking system with deadbolt and one-piece keep

Stainless steel rollers

Accommodates standard 28mm glazed units

Dedicated 46mm outer frame and sash heights of 95mm

Low sightline co-extruded gasket

Available in bevelled and fully sculptured sash options and dedicated beading

Unique dual purpose anti-lift/sash stabilizing trim which increases security and assists in smooth location of lock into keep plate

Bespoke midrail accepts letterplates

Available in brilliant white and standard white plus woodgrains, standard and special colours including rosewood

Handles available in chrome, satin, polished gold, black and white as standard

Aluminium low threshold with ramp option, enabling easy access for wheelchair users

Standard cill options: 85mm, 150mm, 180mm and 225mm

Maximum sizes by combination:

2 pane Max width: 3040mm Max height: 2430mm

3 pane Max width: 4590mm Max height: 2430mm

4 pane Max width: 5950mm Max height: 2430mm

10 year guarantee





slidersuk

Contact a member of the sales team on 01772 698222
or email sales@sliders-uk.com to find out more.

www.sliders-uk.com



High precision manufacture

We employ the strictest quality management system, going far beyond our BSI approved controls.

This includes the manufacture of doors on rigs, which means that all running and door operation is fully tested before doors leave the factory floor.

Fully wrapped and delivered by our dedicated fleet, it means that we're able to offer you guaranteed quality and service.

Images shown are for illustration purposes only.